

## Lincolnshire County Council

### Planning and Regulation Committee – 1<sup>st</sup> October 2018

- Location Map Attached

#### Item 4.1

**Planning Manager** – Proposed Condition 6 be amended to remove '*or other noise measurement methodology*' to ensure only a recognised methodology for noise measurement is used for any noise monitoring that is undertaken.

#### Item 5.2

**Local Landowner** - A further representation from the landowner of the commercial site has been received. It states that they support the objections and concern raised by their tenants and are concerned that a change to the accesses of the site could impact upon those businesses and result in their closure. This would have a detrimental impact on the landowner in terms of revenue and future commerciality of the site. The landowner asks that alternatives to the scheme be considered in particular the use of speed cameras or other traffic management systems to decrease traffic accidents and fatalities.

**Applicant's Response** - The applicant has also provided a response to the concerns raised by the objectors to the scheme. This response summarises what contact/consultation has been made with the businesses about the Consented Scheme and also why alternatives to the Consented Scheme are not considered feasible. It states that a single access shared by the commercial businesses and the adjoining farmer would not be appropriate given the design requirements and legal access issues. Any agricultural land/crops lost as a consequence of the new access point would be compensated and a separate field access will be provided.

**Planning Manager** – This application relates to a proposal to provide 2 additional accesses to the commercial site in conjunction with the Consented Scheme. Planning permission for the Consented Scheme itself already exists and the issues raised in these further representations/comments are already addressed in paragraphs 21 and 24-26 of the report.

This page is intentionally left blank



## 4.1

LINCOLNSHIRE COUNTY COUNCIL  
PLANNING AND REGULATION COMMITTEE 1 OCTOBER 2018

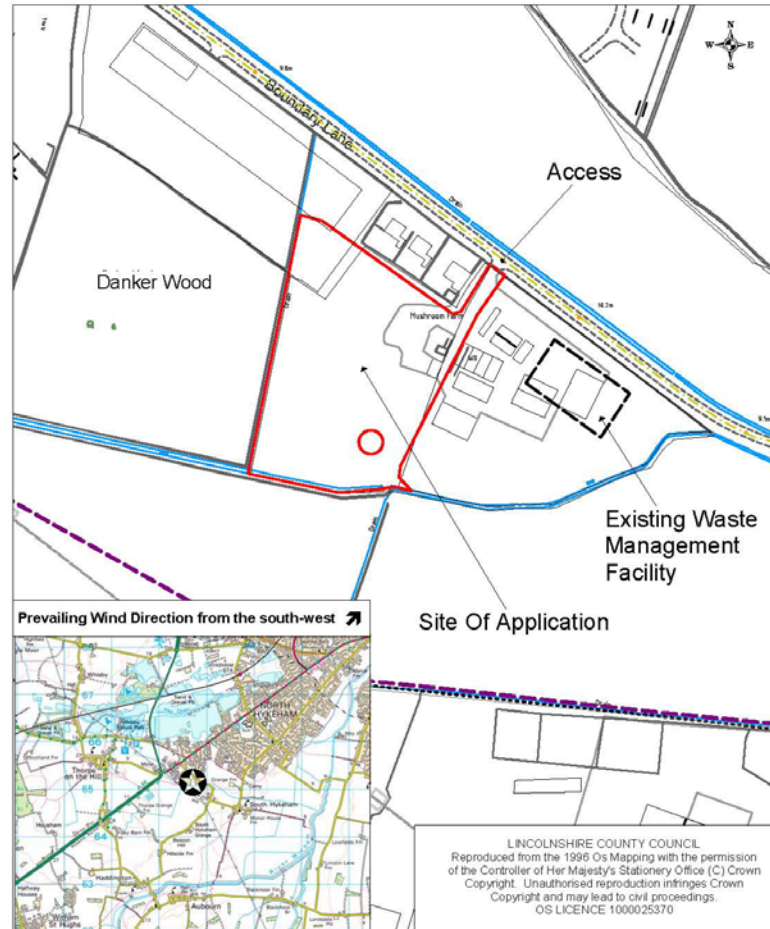

**Location:**  
Mushroom Farm  
Boundary Lane  
South Hykeham

**Application No:** 18/1096/CCC  
**Scale:** 1:2500

**Description:**

For the erection of General Purpose Building for storage and maintenance of plant and equipment, external storage of skips, plant and equipment as an extension to the adjacent MRF and the installation of bays for the storage, sale and distribution of recycled and imported aggregate

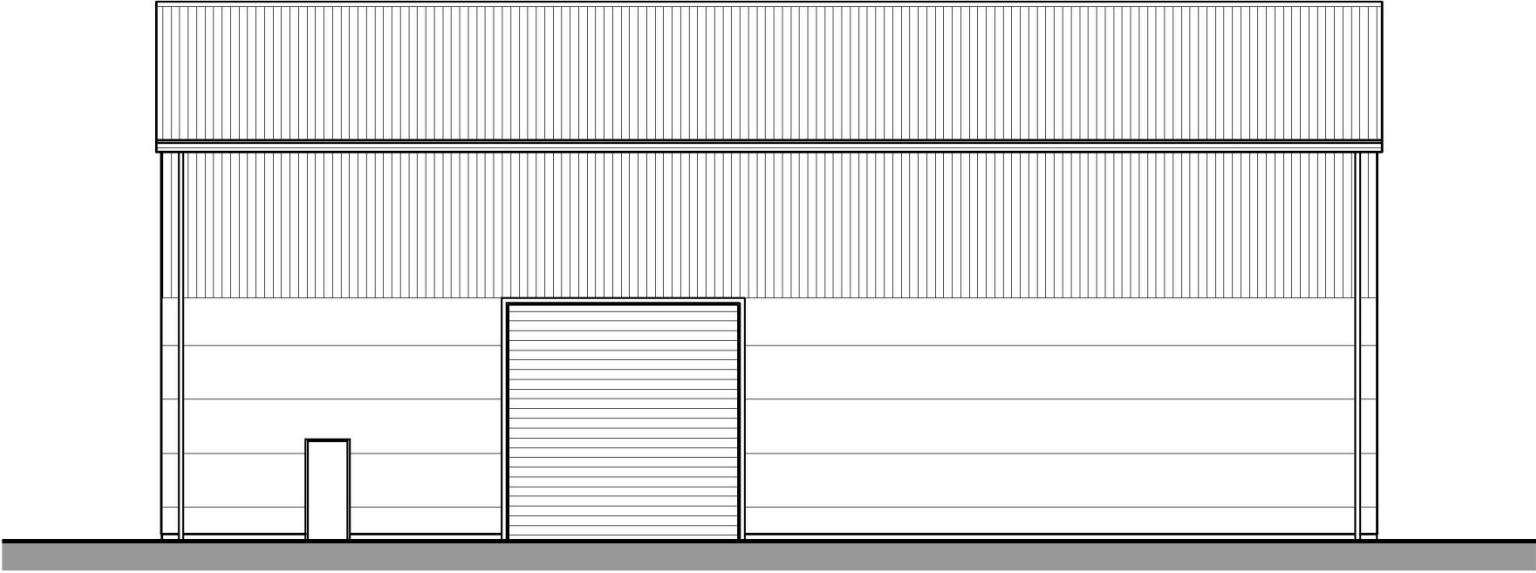
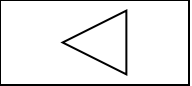

East Elevation  
1:100



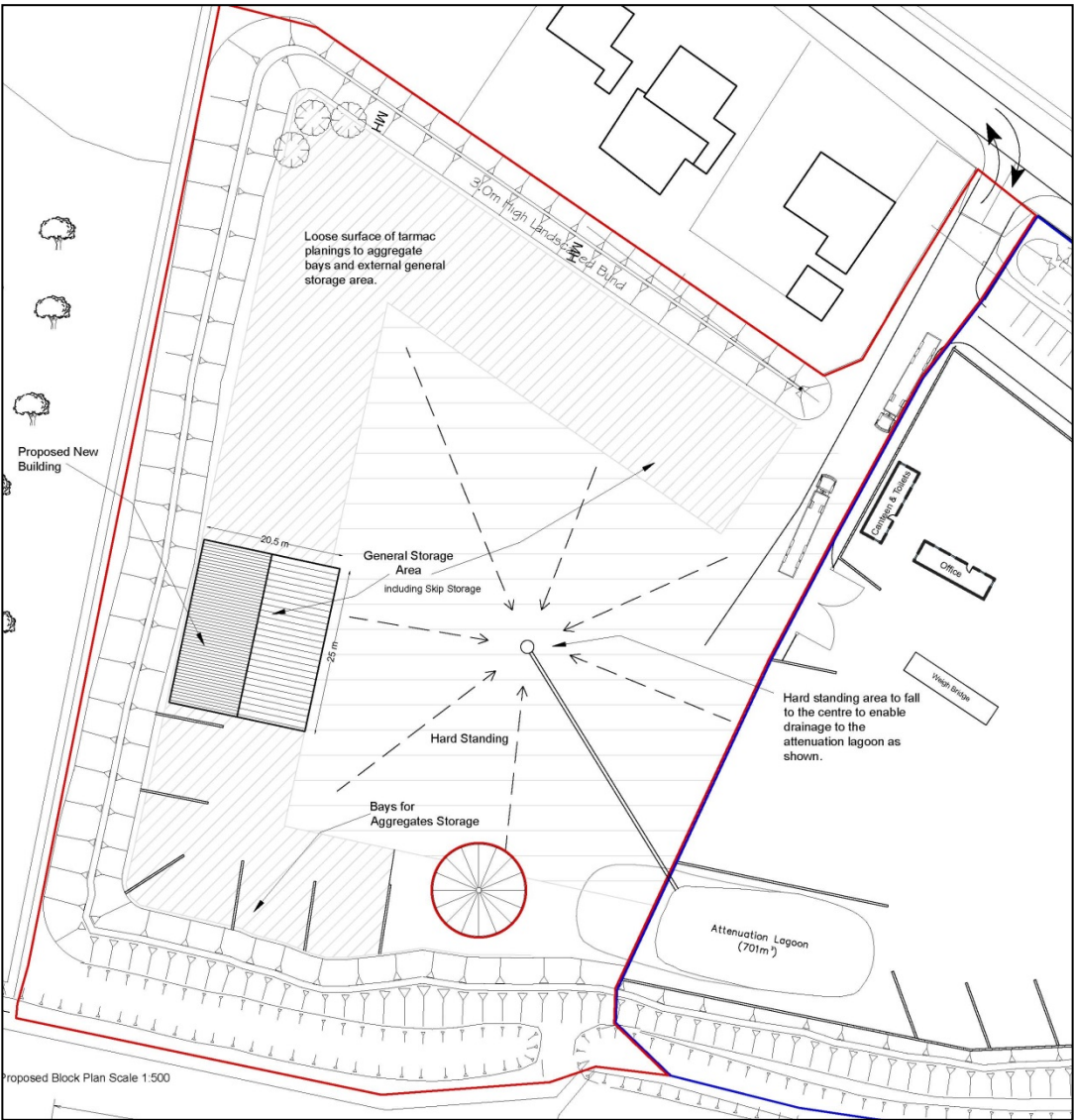





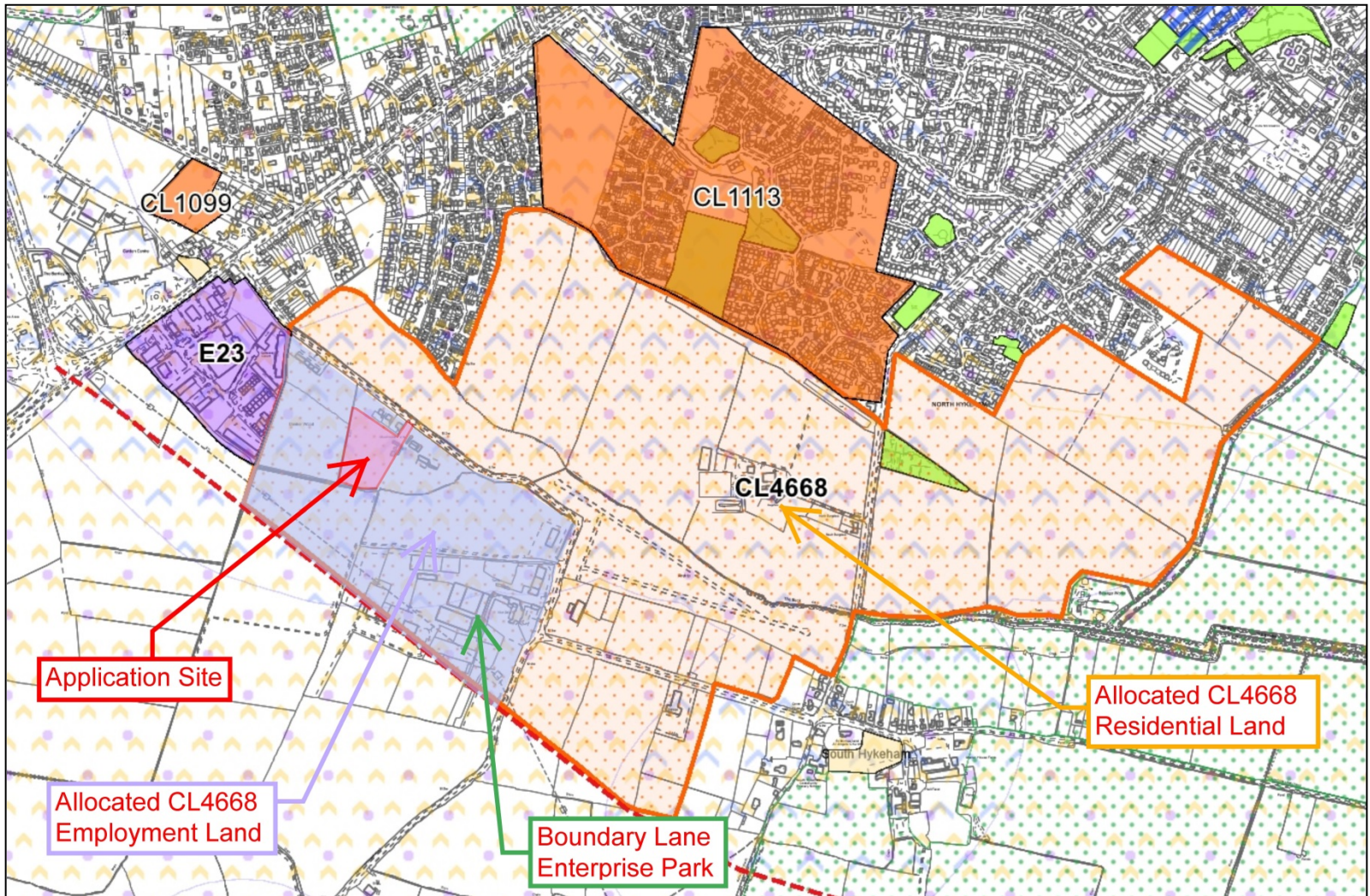







## 5.1

### LINCOLNSHIRE COUNTY COUNCIL PLANNING AND REGULATION COMMITTEE 1 OCTOBER 2018

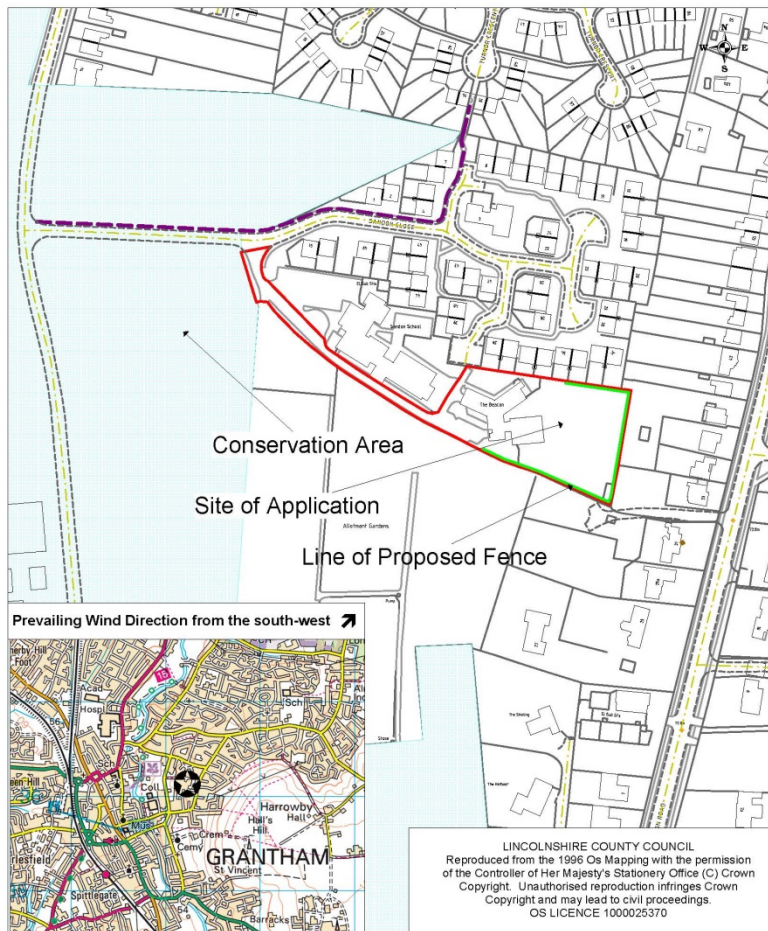

**Location:**  
The Beacon Children's Centre  
Sandon Close  
Grantham

**Application No:** S18/1490

**Scale:** 1:2000

**Description:**

To vary condition 2(b) of planning permission number S35/0922/16 - To remove and replace the existing 2.5m high fencing with 3.6m high mesh palladin fencing in the same colours as the existing (green)













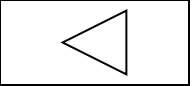









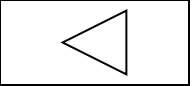









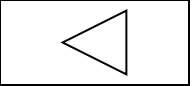



## 5.2

### LINCOLNSHIRE COUNTY COUNCIL PLANNING AND REGULATION COMMITTEE 1 OCTOBER 2018

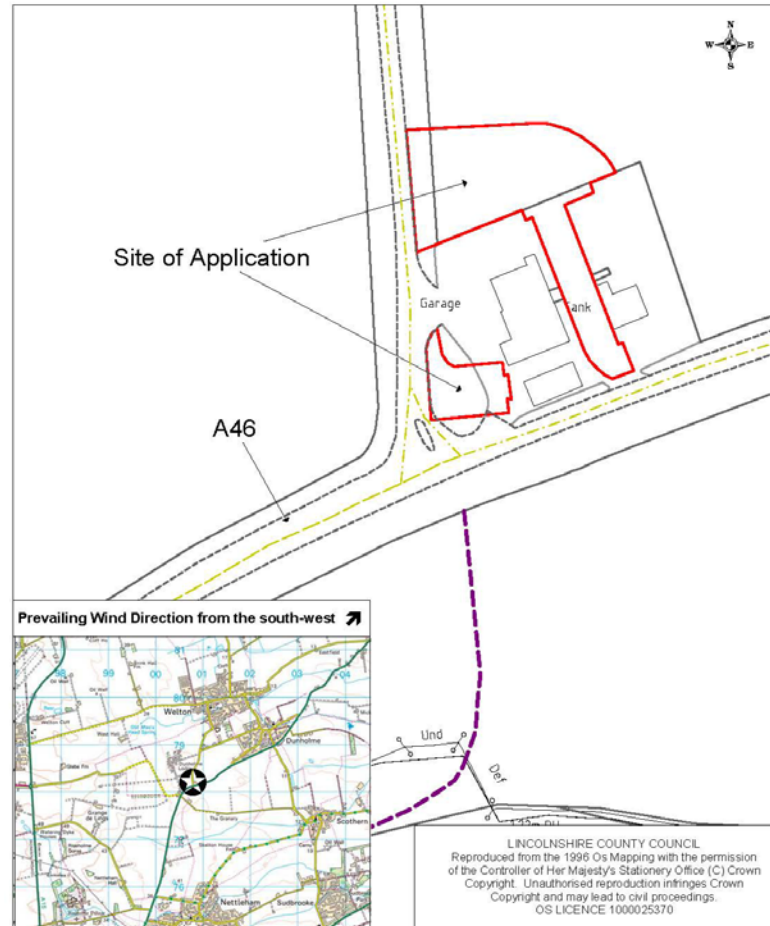

**Location:**  
Commercial Site  
A46/Lincoln Road Junction  
Dunholme  
**Application No:** 138194  
**Scale:** 1:1250

**Description:**  
For the construction of a northern access and  
southern access into the commercial site at the  
junction of the A46 / Lincoln Road (Dunholme),  
Lincoln



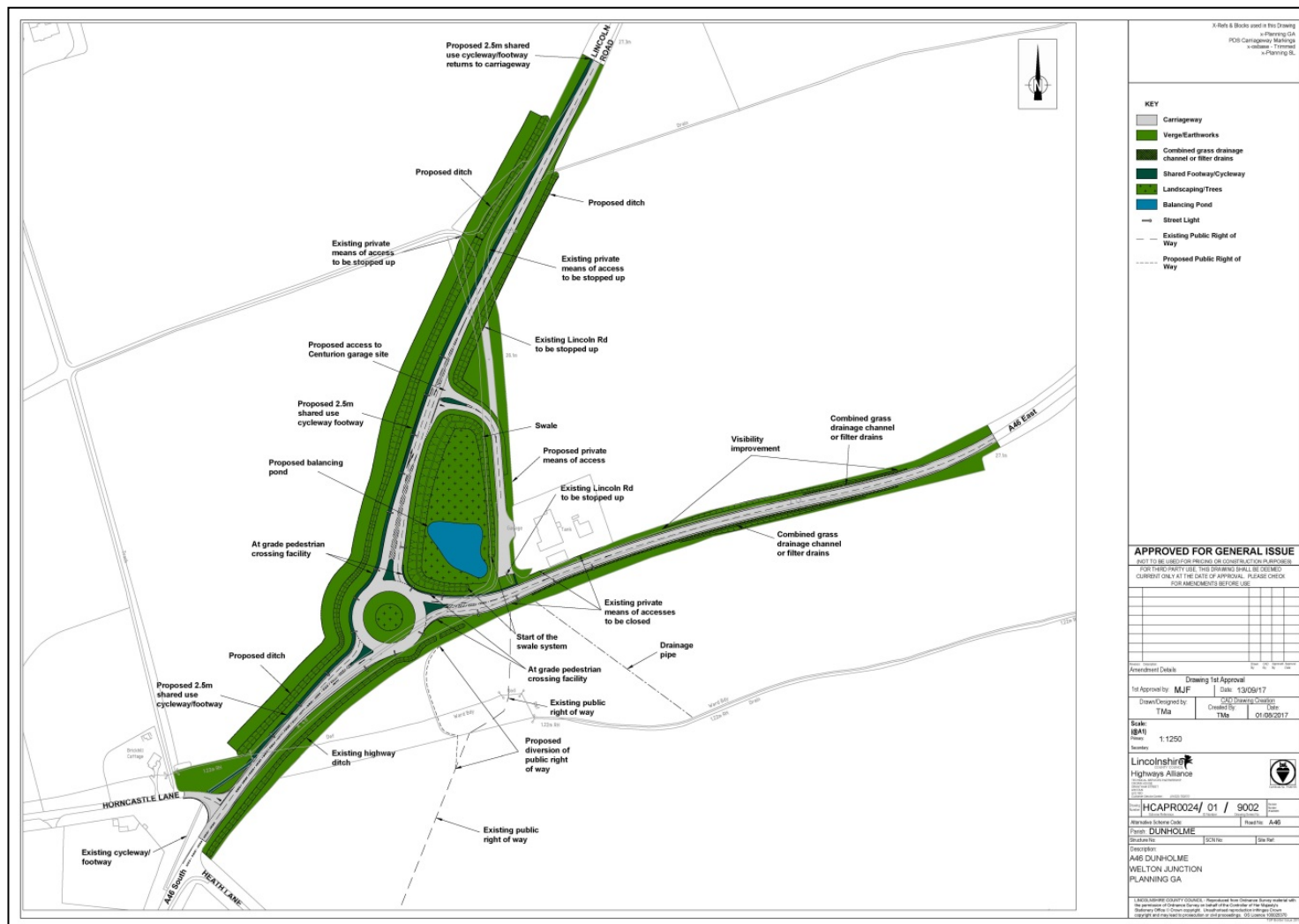











06/08/2018



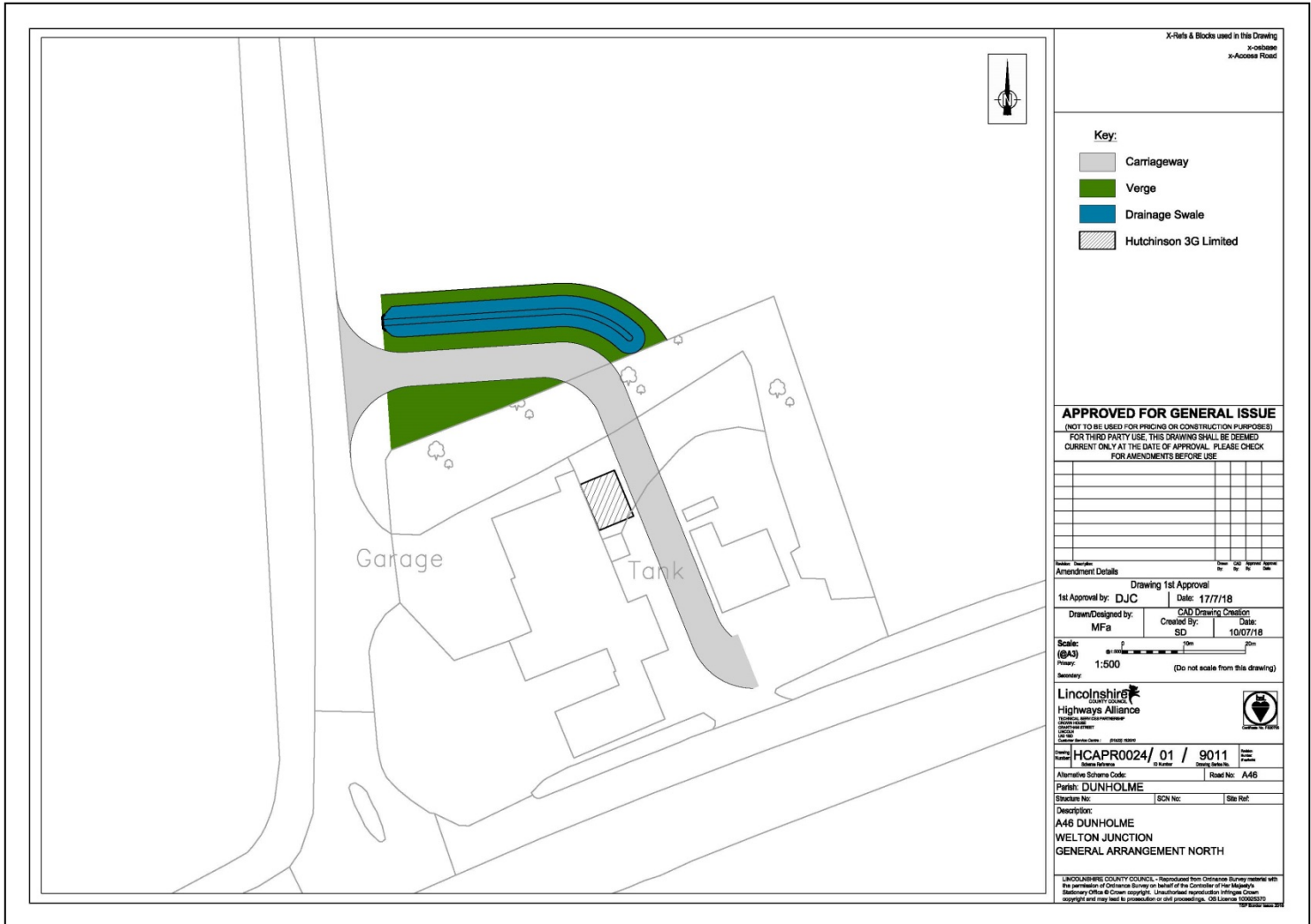

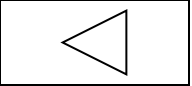







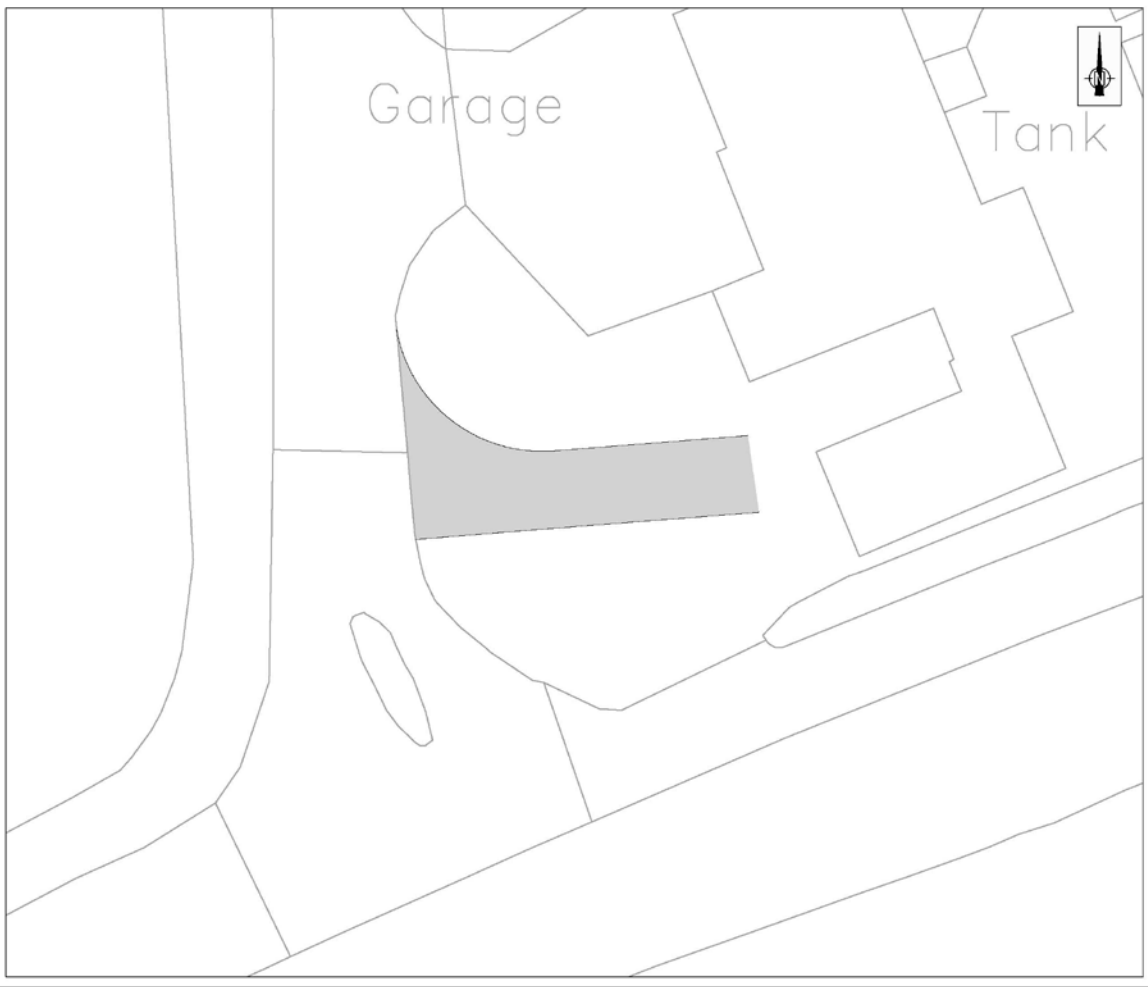
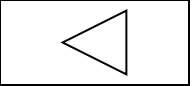

X-Refs & Blocks used in this Drawing

### Key

**APPROVED FOR GENERAL ISSUE**

FOR THIRD PARTY USE, THIS DRAWING SHALL BE DEEMED  
CURRENT ONLY AT THE DATE OF APPROVAL. PLEASE CHECK  
FOR AMENDMENTS BEFORE USE

Amendment Details	Draw By	CD By	Approved By	App Date
-------------------	------------	----------	----------------	-------------

Drawing 1st Approval  
1st Approval by: DJC | Date: 17/7/18

Drawn/Designed by: MFa	CAD Drawing Creation	
	Created By: SD	Date: 10/07/18

Scale: (GAS)  
1:250

Secondary: \_\_\_\_\_

**Lincolnshire**  
COUNTY COUNCIL  
**Highways Alliance**  
TECHNICAL SUPPORT PARTNERSHIP  
CULPIN HOUSE  
CULPIN ROAD (A1033)  
LINCOLN  
LN1 1SD  
Tel: 01522 525252  
Fax: 01522 525251

HCAPR0024/ 01 / 9012	Revision Number of sheets
Scheme Reference	IC Number
Design Series No.	
Approval Scheme Order	Approval Mark
	A 4.0

Parish: DUNHOLME

Structure No.	GCY No.	Unit No.
Description:		

A46 DUNHOLME  
WELTON JUNCTION  
GENERAL ARRANGEMENT SOUTH

LIVINGS-IRE COUNTY COUNCIL - Reproduced from Ordnance Survey material with the permission of Ordnance Survey on behalf of the Controller of Her Majesty's Stationary Office © Crown copyright. Unauthorised reproduction infringes Crown copyright and may lead to prosecution or civil proceedings. OS Licence 1000295370









This page is intentionally left blank